



Nouvelle



Live your way!



Nouvelle

WIDTH: 11.67m

LENGTH: 20.13m

TOTAL: 207m²

4 2 2 1

BREEZY OPEN PLAN LIVING

The Nouvelle is designed to let light in. Concealed sliding stacker doors seamlessly blend the living and dining areas with the outdoor alfresco area, filling the open plan living area with fresh air and daylight.

Through a luxurious wide entry way, this home features a master suite complete with walk-in robe, three additional bedrooms, sitting area and study nook.

If you are looking for a home perfectly designed for breezy open plan living on one floor, the Nouvelle is the one for you.

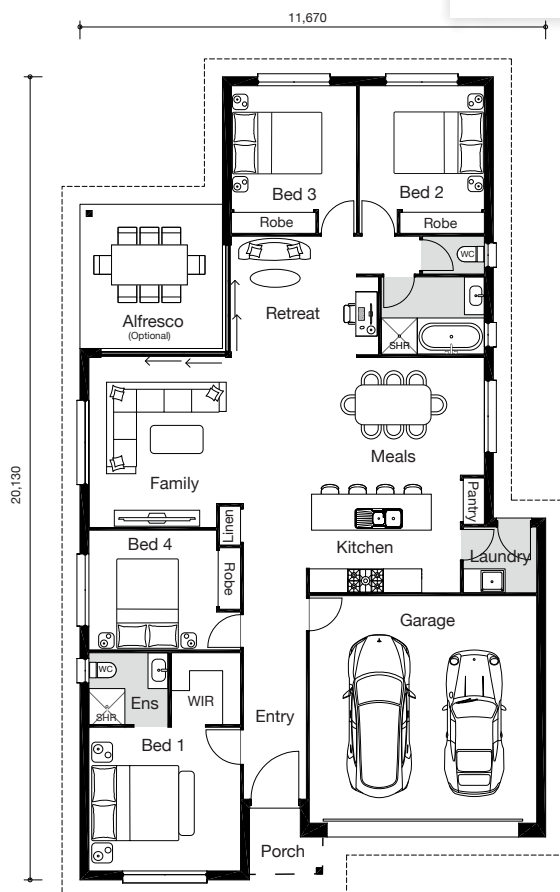

CLASSIC



ELITE



MODERN

“Customise our flexible floorplans”

OWNITHOMES.COM.AU

*This exclusive design is a product of Ownit Homes and is protected by copyright law. In accordance with Ownit Homes' policy of continued design improvement, we reserve the right to alter the plans, specifications and inclusions packages without prior notice. This floor plan is for illustration purposes only and does not form part of any contract. Ownit Homes QBCC #6479.

**OWNIT
HOMES**
EST.1972